

OKTAL-SE facilities

SC24 2018

Jean Latger & Carole Nissoux

www.oktal-se.fr

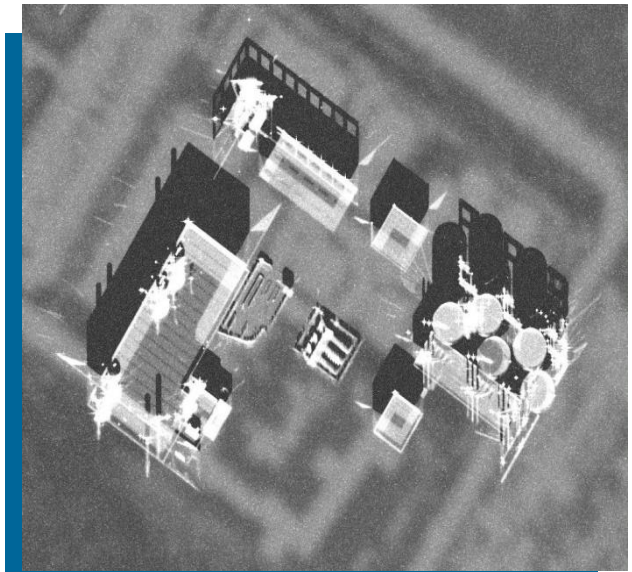
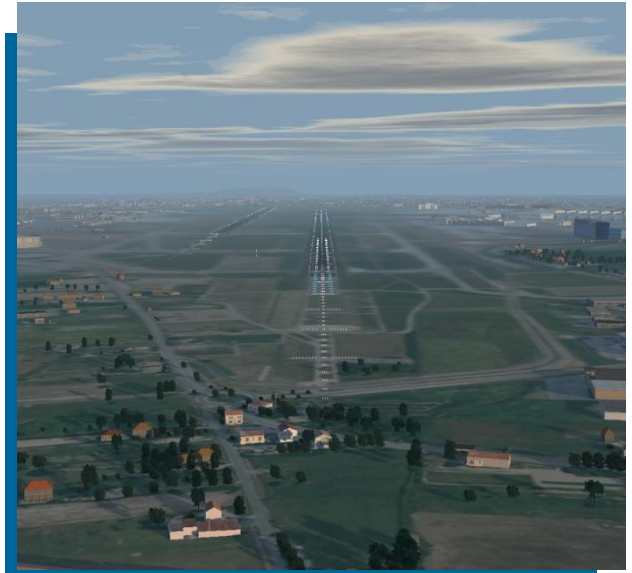

Agenda

SC24 2017 - OKTAL-SE

OKTAL-SE is pleased to offer to host the 2018 SC 24 Meetings at the OKTAL-SE facilities in Toulouse, France

- Overall 2018 plans
- Venue/location (OKTAL-SE offices)
- Facility capabilities
- Nearby towns/restaurants/hotels
- Daily transportation to/from the meeting location
- Transportation to/from Toulouse
- Possible social event

Overall 2018 plans

- OKTAL-SE is coordinating with AFNOR (French Standards Body)
- Week 33 of 2018 (13-17 August) is proposed
- The entire OKTAL-SE facility could be available during that week

Venue/location (Oktal-SE offices)

SC24 2017 - OKTAL-SE

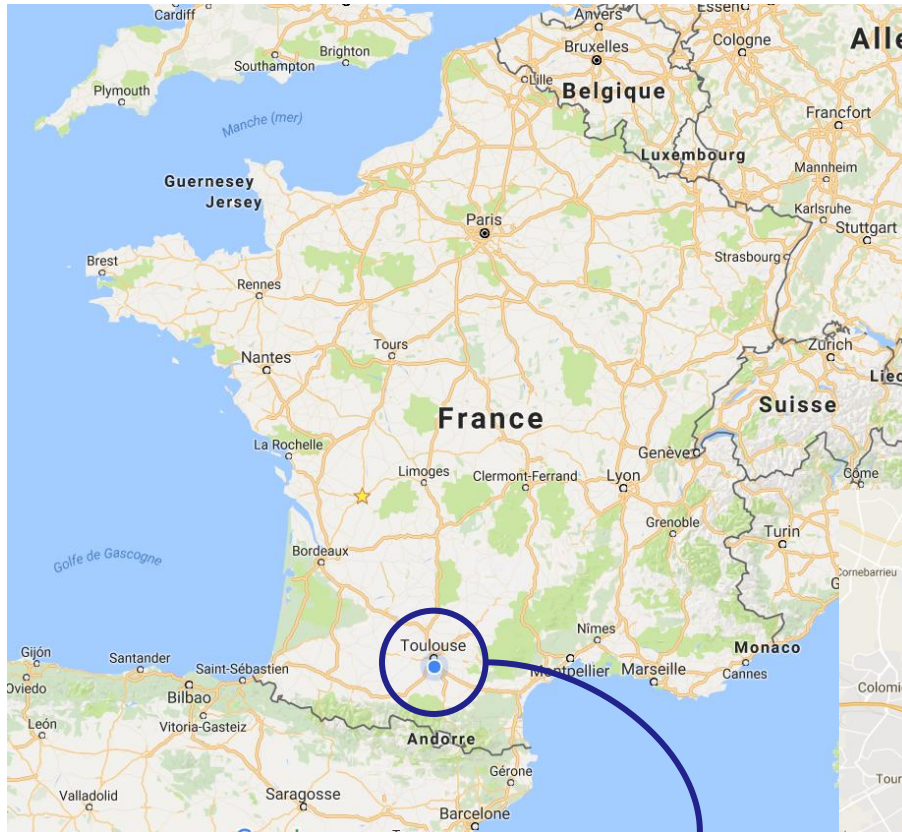

In the hillside of
Toulouse



Venue/location (Oktal-SE offices)

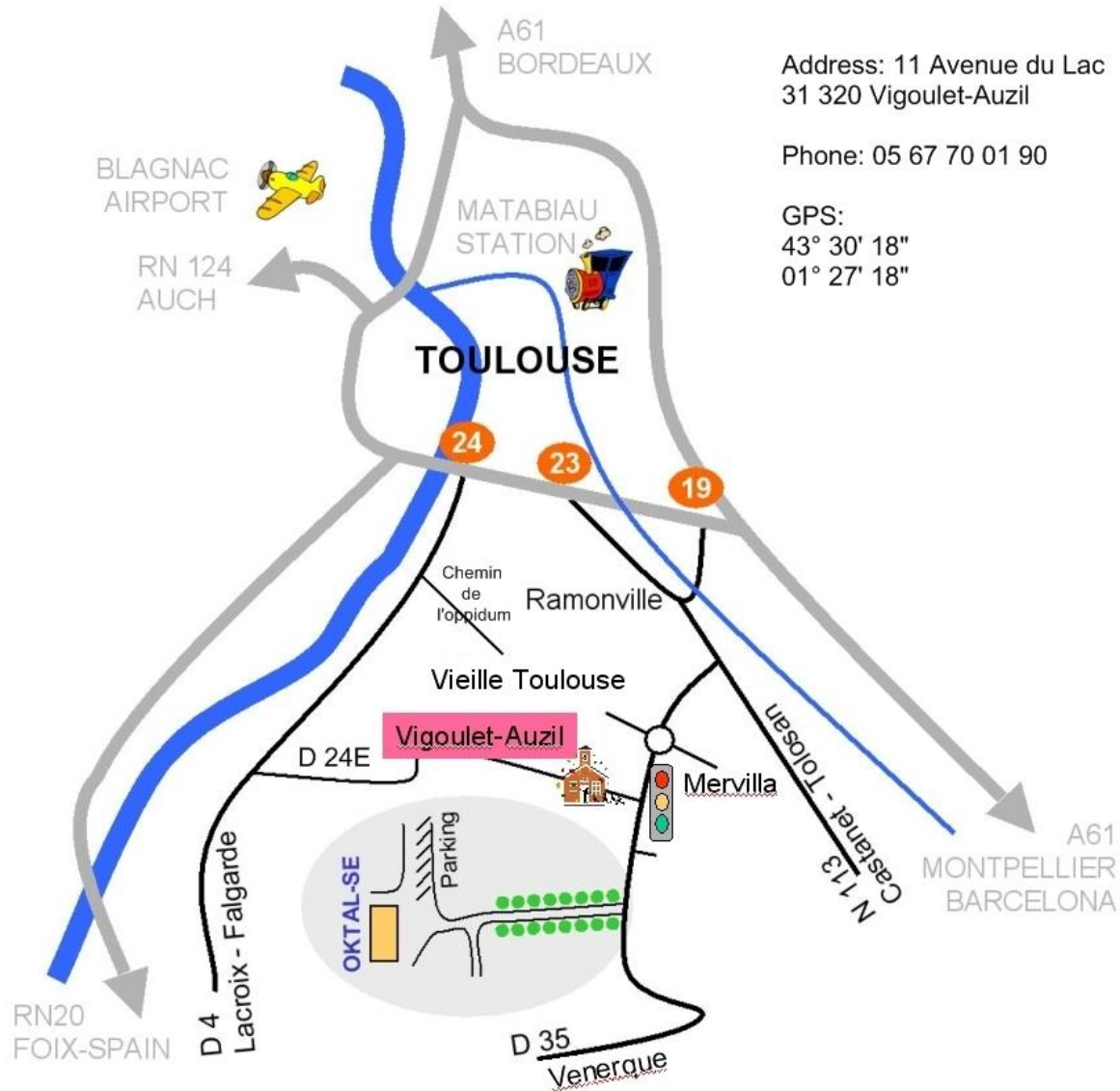

Venue/location (Oktal-SE offices)

SC24 2017 - OKTAL-SE



Venue/location (Oktal-SE offices)

SC24 2017 - OKTAL-SE

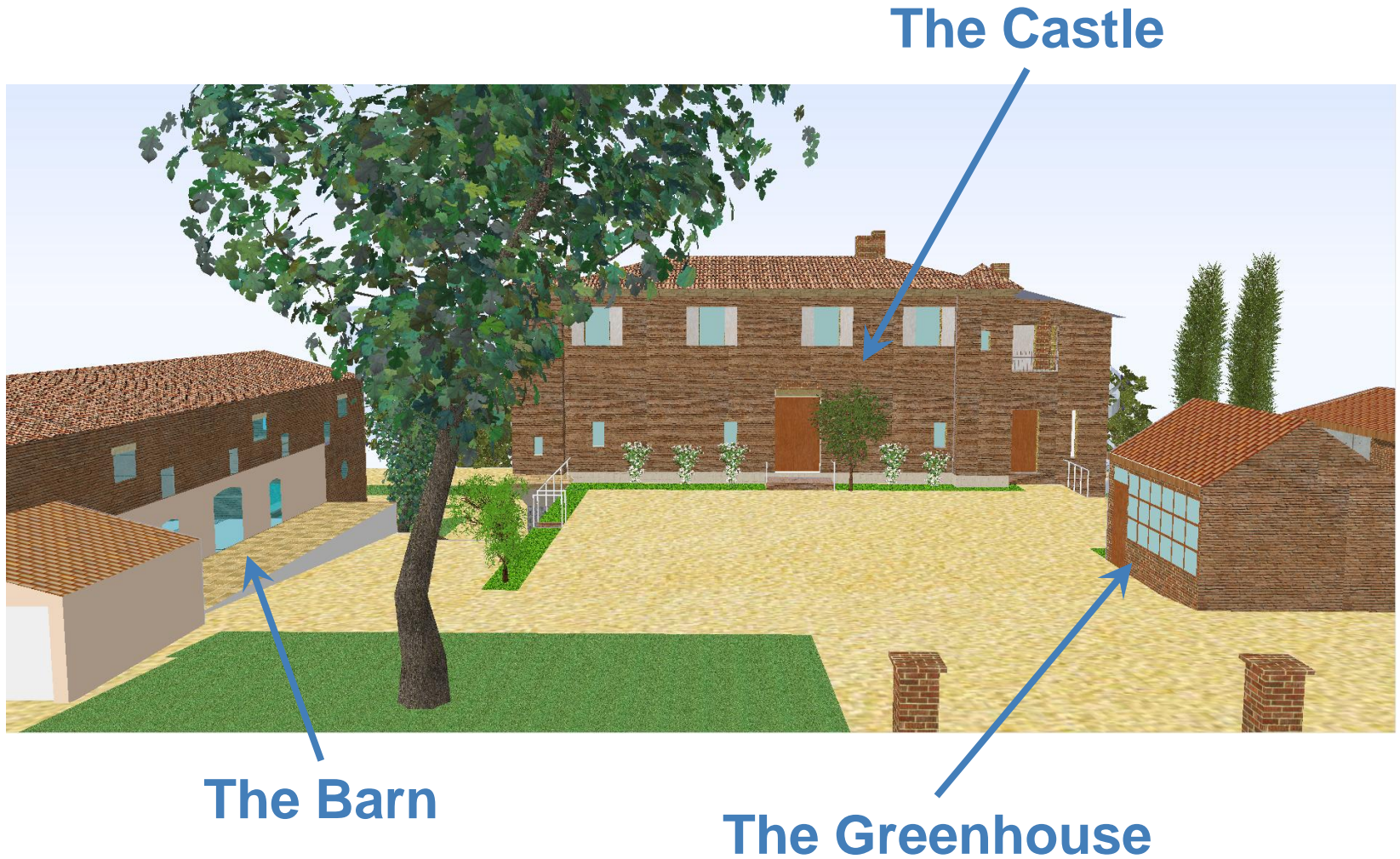

Facility capabilities

The Castle:



- One big conference room with big adjoining coffee room with a projector
- Possibly another conference room of the same size in the employees lunch room for big working group
- Telephone, projector

Facility capabilities

The Greenhouse:



- One medium conference room
- WiFi, telephone, projector

Facility capabilities

The Barn:



- Much more space!
- Wifi, telephone, projector

Facility capabilities

The Barn: top floor

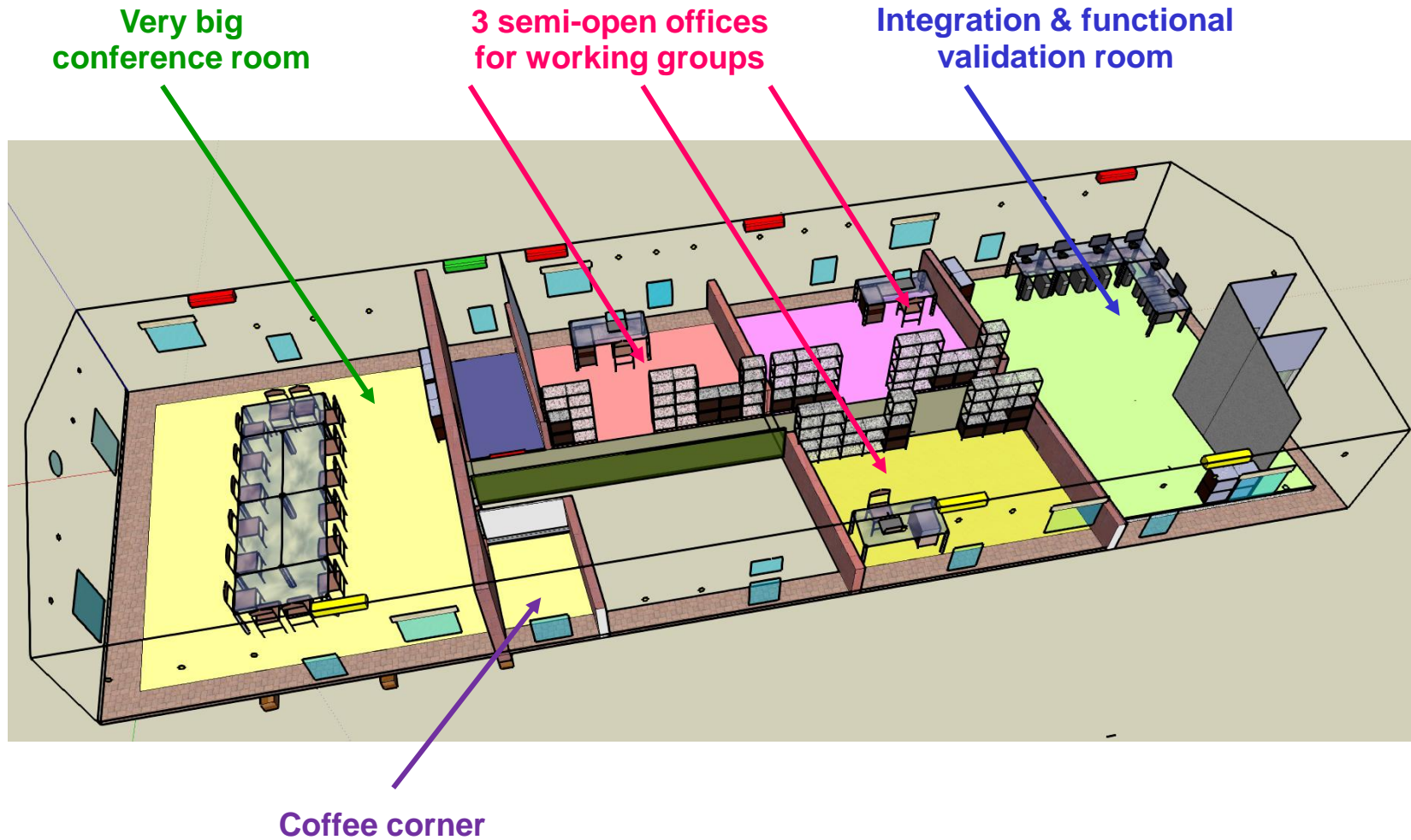

Facility capabilities

The Barn:



SC24 2017 - OKTAL-SE

Facility capabilities

The Barn: ground floor

6 offices for small working groups
or individual work

Coffee room

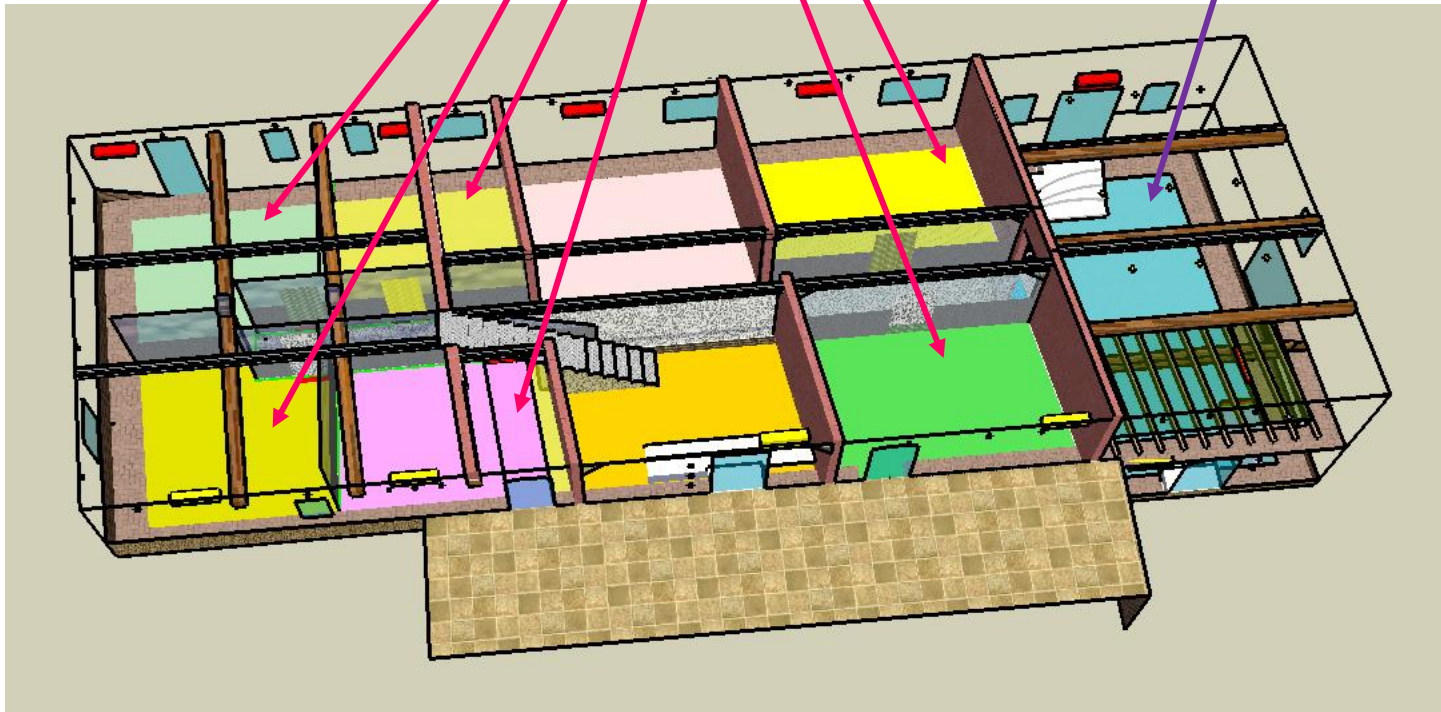

Facility capabilities

SC24 2017 - OKTAL-SE



A 3 hectares park!

(squirrels, deers, birds... and sometimes wild boars...)

Nearby towns/restaurants/hotels

Restaurants: from McDonald's to very fancy and expensive restaurants...



BUT you will need your own car... Except for L'auberge du Tournebride

Nearby towns/restaurants/hotels

Hotels: La Flanerie - hotellaflanerie.com

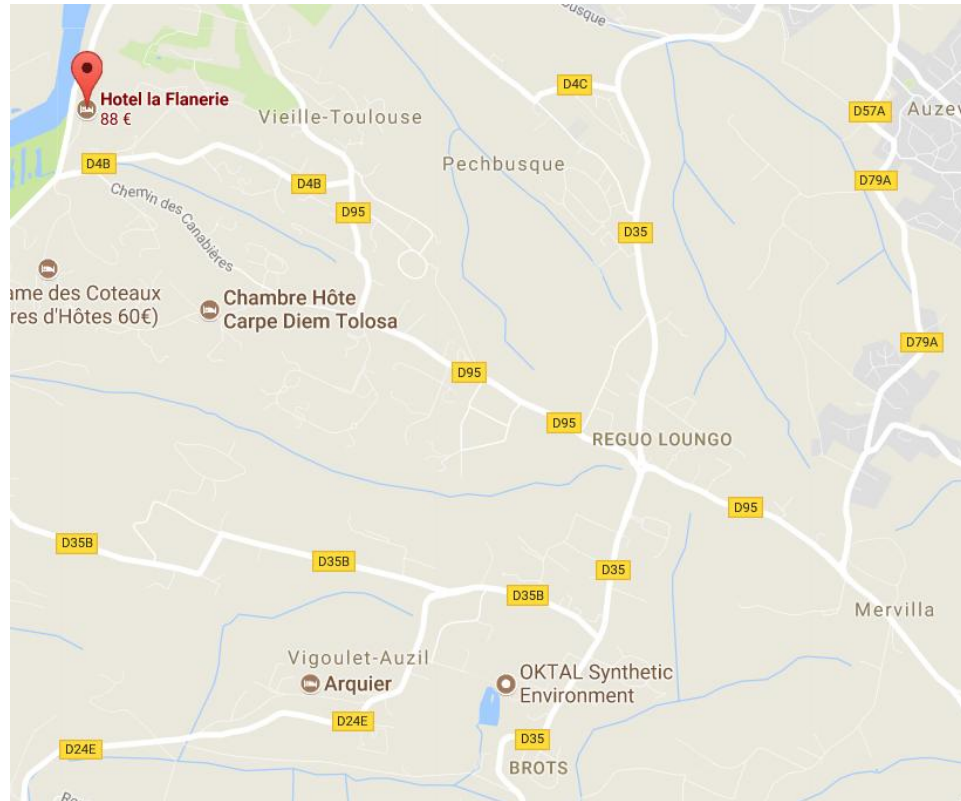

BUT you will need your own car...

Nearby towns/restaurants/hotels

Bed & Breakfast:



BUT you will need your own car...

Nearby towns/restaurants/hotels

What we recommend: staying in downtown Toulouse

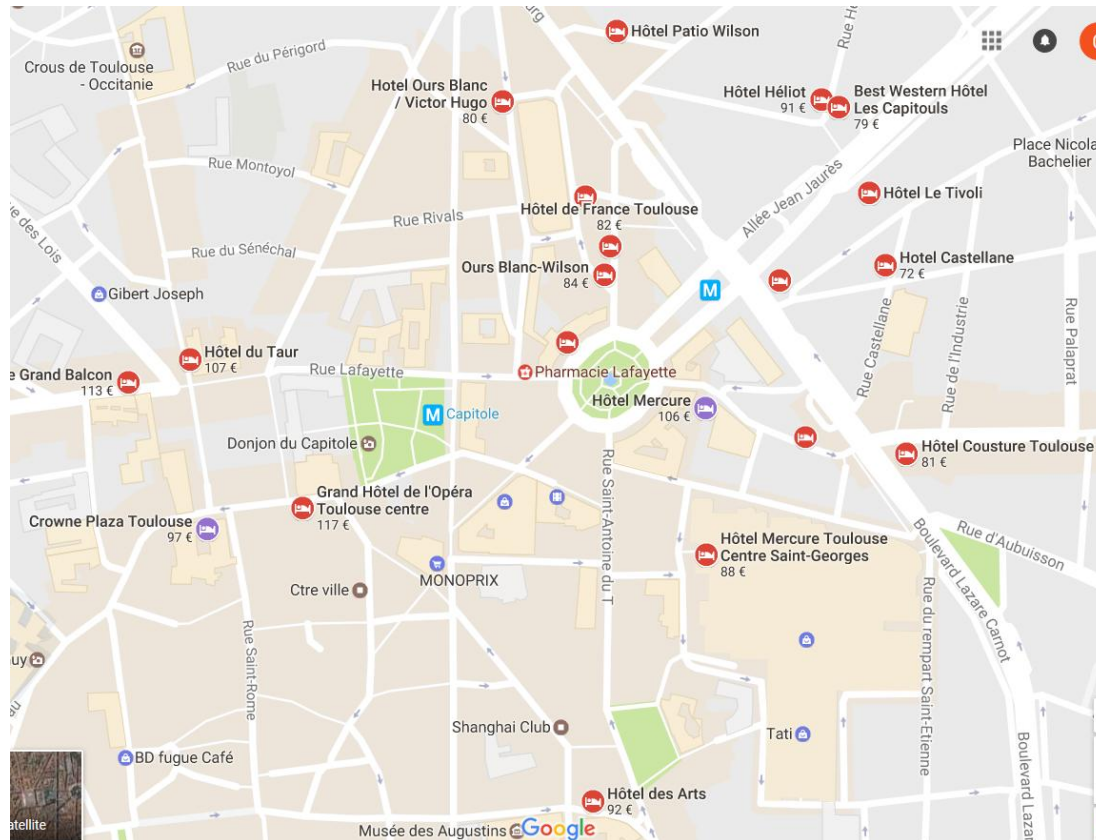

Hotels, restaurants, tourism, public transportation...
civilisation!

Daily transportation to/from the meeting location

For those who will choose to stay near OKTAL-SE outside the city: the car...

For those staying downtown: public transportation are not very convenient...

Subway, B line, until the terminus and then “transportation on demand”
⇒ quite long

⇒ We think of renting a bus...
(same duration as a car, roughly 30 minutes with the traffic)



Daily transportation to/from the meeting location

Lunches could be brought to us in the Castle by a caterer
And/or we could walk to a nearby restaurant (and use some of our cars for those who cannot walk so far away)

For those who want, they can prepare their own meal and use our kitchen fridge and micro-wave ovens

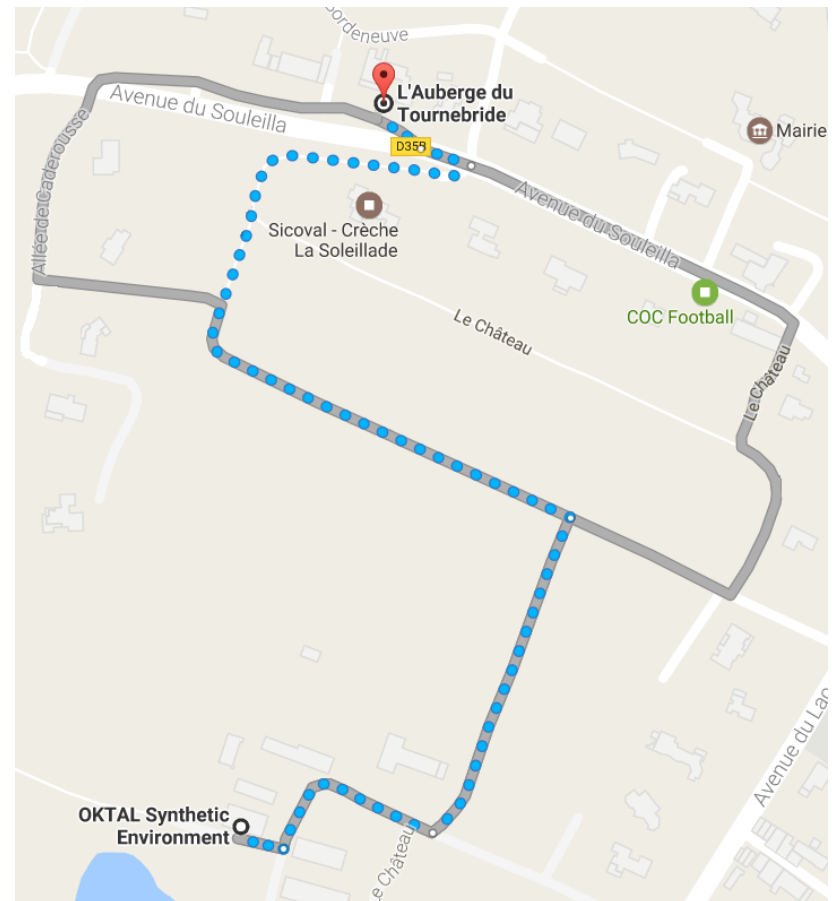

Transportation to/from Toulouse

SC24 2017 - OKTAL-SE

Airport
(direct
tramway to
downtown)

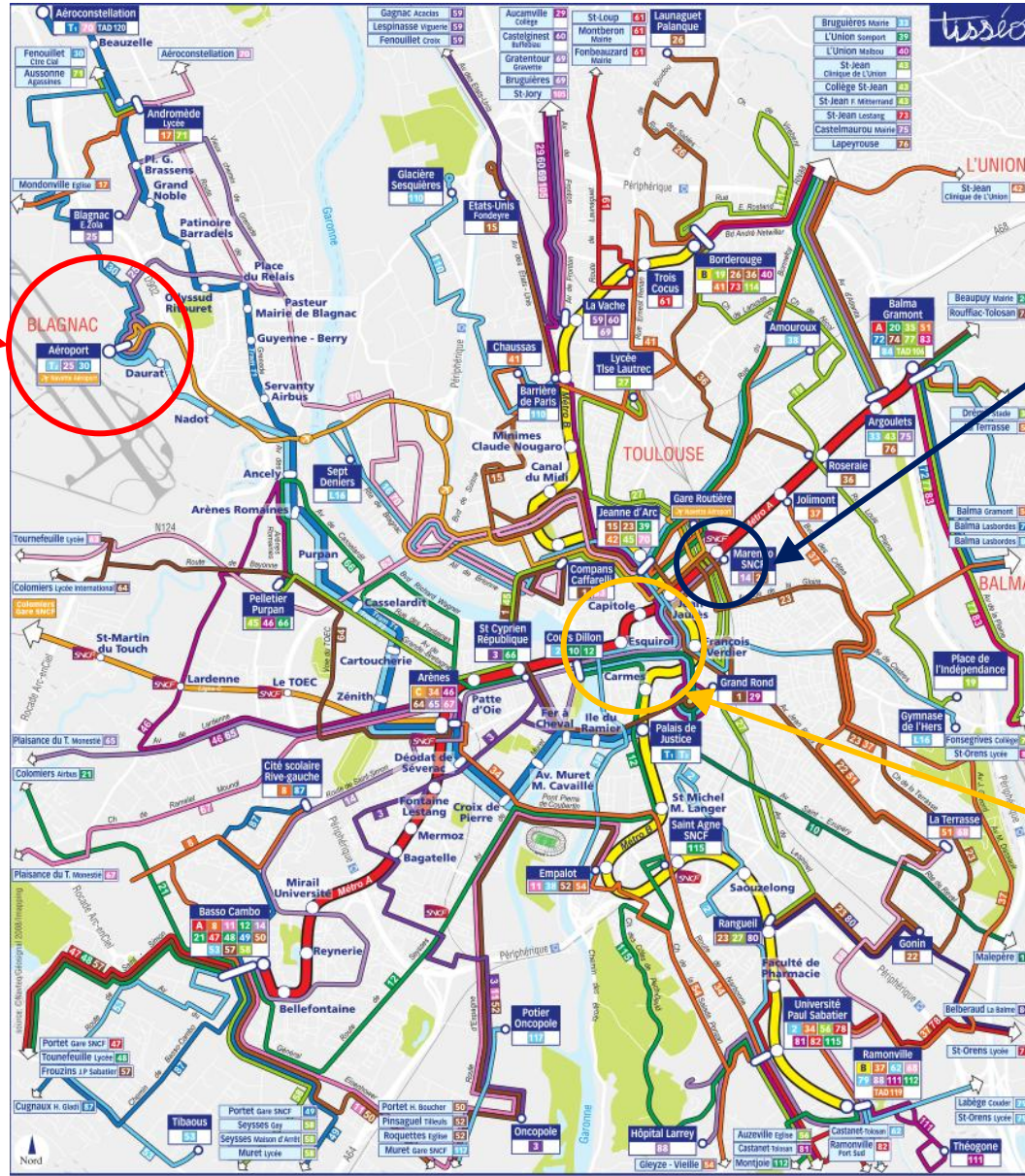

Train station

Downtown

Possible social event

Many possibilities... We already have some ideas that we will study:

- A cruise on the Garonne river
- Something around French vine, may be at the castle
- A good French restaurant (so you can taste French South West cuisine...)
- ...



Contacts

OKTAL Synthetic Environment
11 avenue du Lac
31320 VIGOULET AUZIL - FRANCE
+33 (0)5 67 70 02 00
Web site: www.oktal-se.fr



Contact: contact@oktal-se.fr

CEO: Jean LATGER
Assistant: Ingrid GAU